

SCT

開縫型 / 止付螺絲固定式 / 撓性聯軸器

SCTS

SLITTED / SET SCREW TYPE / FLEXIBLE COUPLING



材質 | Material

SCT 系列-鋁合金 Aluminum alloy
SCTS 系列-不銹鋼 Stainless steel

表面處理 | Surface Treatment

SCT-陽極處理 Anodizing standard white

特性 | Features

- | | |
|-----------------------------|--|
| 1. 一體成型 | • One-body shape |
| 2. 零背隙 | • Zero backlash |
| 3. 剛性大 | • High rigid |
| 4. 適合譯碼器、小馬力傳動機構、
高精密傳動上 | • Suitable for encoder、low horsepower
transmission bodies and high precision
transmission mechanism. |
| 5. 偏角誤差較佳 | • High deflection |
| 6. 不銹鋼材質扭力較佳 | • Torque in SUS is better |
| 7. 固定方式：止付螺絲固定式 | • Fixed mode : Set screw type |

型號表示 | Product NO

SCT-20- $\phi 5 \times \phi 5$

型號 / Type 孔徑 / Inside dia

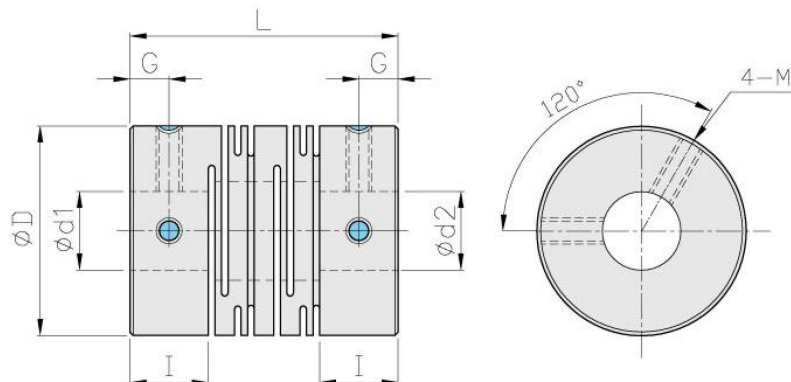

尺寸 | Dimension

單位 / Unit:mm

Catalog Number 型號	D	I	L	G	M	d1xd2 標準孔徑 (H7)		Mass** 重量 (g)
						Min	Max	
SCT-8	8	3.5	14.0	1.7	M2	2	4	1.3
SCT-12	12	5.0	18.5	2.5	M2.5	3	6	4.5
SCT-16	16	6.5	23.0	3.0	M3	4	8	9.5
SCT-20	20	7.5	26.0	3.0	M4	5	10	16.0
SCT-25	25	8.5	31.0	4.0	M4	5	12	30.0
SCT-32	32	12.0	41.0	6.0	M5	6	14	65.0
SCT-40	40	15	56.0	8.5	M5	8	20	120.0
SCT-50	50	18	71.0	10.5	M6	12	25	230.0
SCT-63	63	22	90.0	13.0	M8	15	35	470.0
SCTS-12	12	5	18.5	2.5	M2.5	3	6	14.0
SCTS-16	16	6.5	23.0	3.0	M3	4	8	28.0
SCTS-20	20	7.5	26.0	3.0	M4	5	10	45.0
SCTS-25	25	8.5	31.0	4.0	M4	6	12	95.0
SCTS-32	32	12	41.0	6.0	M5	6	14	220.0
SCTS-40	40	15	56.0	8.5	M5	8	20	350.0
SCTS-50	50	18	71.0	10.5	M6	12	25	700.0
SCTS-63	63	22	90.0	13.0	M8	15	35	1300.0

性能 | Specifications

單位 / Unit:mm

Catalog Number 型號	Rated Torque 一般扭力 (N.m)	Max. Torque 最大扭力 (N.m)	Max Rotational Frequency 最高回轉速 (Rpm/min)	Moment* of Inertia 慣性 (Kg · m ²)	Errors of Eccentricity 容許偏心 (mm)	Errors of Angularity 容許偏角 (°)	Errors of Shaft End-Play 容許軸向位差 (mm)
SCT-8	0.1	0.2	48000	1.2x10 ⁻⁸	0.10	2	±0.2
SCT-12	0.2	0.4	32000	8.3x10 ⁻⁸	0.10	2	±0.3
SCT-16	0.3	0.6	24000	3.3x10 ⁻⁷	0.10	2	±0.4
SCT-20	0.5	1.0	19000	9.0x10 ⁻⁷	0.10	2	±0.4
SCT-25	1.0	2.0	15000	2.6x10 ⁻⁶	0.15	2	±0.5
SCT-32	2.0	4.0	12000	9.6x10 ⁻⁶	0.15	2	±0.5
SCT-40	5.0	10.0	9600	3.2x10 ⁻⁵	0.20	2	±0.5
SCT-50	10.0	20.0	7700	1.0x10 ⁻⁴	0.20	2	±0.5
SCT-63	20.0	40.0	6100	3.2x10 ⁻⁴	0.20	2	±0.5
SCTS-12	0.3	0.6	32000	2.1x10 ⁻⁷	0.10	2	±0.3
SCTS-16	0.5	1.0	24000	8.4x10 ⁻⁷	0.10	2	±0.3
SCTS-20	1.0	2.0	19000	2.4x10 ⁻⁶	0.10	2	±0.3
SCTS-25	2.0	4.0	15000	6.8x10 ⁻⁶	0.15	2	±0.4
SCTS-32	3.5	7.0	12000	2.6x10 ⁻⁵	0.15	2	±0.5
SCTS-40	8.0	16.0	9600	8.7x10 ⁻⁵	0.20	2	±0.5
SCTS-50	15.0	30.0	7700	2.7x10 ⁻⁴	0.20	2	±0.5
SCTS-63	35.0	70.0	6100	8.4x10 ⁻⁴	0.20	2	±0.5

SCT.SCTS 標準孔徑 | Stock Bores

單位 / Unit:mm

Catalog Number 型號	Stock Bores 標準孔徑 d1xd2(公差H7)													
	2	3	4	5	6	6.35	8	9.525	10	12	14	15	16	18
SCT - 8 SCTS - 8	●	●	●											
SCT - 12 SCTS - 12		●	●	●	●									
SCT - 16 SCTS - 16			●	●	●	●	●							
SCT - 20 SCTS - 20				●	●	●	●	●	●					
SCT - 25 SCTS - 25				●	●	●	●	●	●	●				
SCT - 32 SCTS - 32					●	●	●	●	●	●	●			
SCT - 40 SCTS - 40							●		●	●	●	●	●	●
SCT - 50 SCTS - 50										●	●	●	●	●
SCT - 63 SCTS - 63												●	●	●