

SGS-C 鋼片型 / 夾緊式 / 短型撓性聯軸器

DISK / CLAMP TYPE / SHORTER OF FLEXIBLE COUPLING



材質 | Material

鋁合金 Aluminum alloy
緩衝材: 不銹鋼彈片
Buffer material: SUS disk

表面處理 | Surface Treatment

陽極處理 Anodizing standard white

特性 | Features

1. 高剛性
 2. 扭力大
 3. 低慣性
 4. 零背隙
 5. 適用於工作母機、伺服馬達、高精密傳動
 6. 固定方式: 夾緊式
- High rigid
 - High torque
 - Low inertia
 - Zero backlash
 - Suitable for working machine、servomotor and high precision transmission mechanism.
 - Fixed mode: Clamp type

型號表示 | Product NO

SGS-27C- $\phi 6 \times \phi 6$
型號 / Type 孔徑 / Inside dia

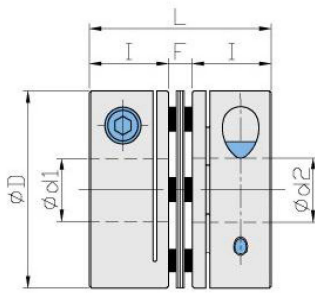

外徑 $\phi 27 \sim \phi 34$

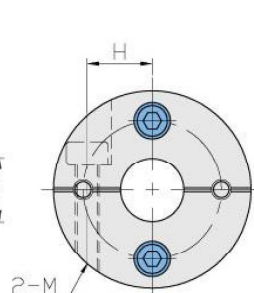

外徑 $\phi 40 \sim \phi 65$

尺寸 | Dimension

單位 / Unit:mm

| Catalog Number 型號 | D | I | F | L | H | M | d1xd2 標準孔徑 (H7) | | Mass** 重量 (g) |
|----------------------|----|------|-----|------|------|----|--------------------|-----|------------------|
| | | | | | | | Min | Max | |
| SGS-27C | 27 | 10.5 | 2.5 | 23.5 | 9.0 | M3 | 5 | 10 | 30 |
| SGS-34C | 34 | 12.0 | 3.0 | 27.0 | 12.0 | M3 | 6 | 14 | 48 |
| SGS-40C | 40 | 15.0 | 4.5 | 34.5 | 14.0 | M4 | 8 | 16 | 93 |
| SGS-45C | 45 | 15.0 | 5.0 | 34.5 | 16.0 | M4 | 10 | 19 | 110 |
| SGS-50C | 50 | 20.0 | 6.0 | 46.0 | 18.0 | M5 | 10 | 22 | 215 |
| SGS-57C | 57 | 20.0 | 6.0 | 46.0 | 21.0 | M5 | 12 | 25 | 240 |
| SGS-65C | 65 | 24.0 | 7.0 | 55.0 | 25.0 | M6 | 12 | 28 | 445 |

性能 | Specifications

單位 / Unit:mm

| Catalog Number 型號 | Rated Torque 一般扭力 (N.m) | Max. Torque 最大扭力 (N.m) | Max Rotational Frequency 最高回轉速 (Rpm/min) | Moment* of Inertia 慣性 (Kg · m ²) | Errors of Eccentricity 容許偏心 (mm) | Errors of Shaft End-Play 容許軸向位差 (mm) | Errors of Angularity 容許偏角 (°) |
|----------------------|----------------------------|---------------------------|---|---|-------------------------------------|---|----------------------------------|
| SGS-27C | 1.5 | 3 | 10000 | 2.5x10 ⁻⁶ | 0.02 | ± 0.15 | 1.0 |
| SGS-34C | 6 | 12 | 10000 | 8.2x10 ⁻⁶ | 0.02 | ± 0.20 | 1.0 |
| SGS-40C | 7 | 14 | 10000 | 19.0x10 ⁻⁶ | 0.02 | ± 0.25 | 1.0 |
| SGS-45C | 10 | 20 | 10000 | 29.7x10 ⁻⁶ | 0.02 | ± 0.30 | 1.0 |
| SGS-50C | 17 | 34 | 10000 | 75.0x10 ⁻⁶ | 0.02 | ± 0.30 | 1.0 |
| SGS-57C | 25 | 50 | 10000 | 100.0x10 ⁻⁶ | 0.02 | ± 0.40 | 1.0 |
| SGS-65C | 25 | 110 | 10000 | 250.0x10 ⁻⁶ | 0.02 | ± 0.40 | 1.0 |